



# TENMAT FF130 FLANGED LOFT CONE



## FITTING INSTRUCTIONS

TENMAT FF130 Flanged Loft Cone:

Suitable for downlight cut-out diameters of 70 - 110mm

“F-Capped” Approved - Can be buried in insulation

Meets AS/NZS 3000:2007 & other international standards for a lighting product when covered with insulation

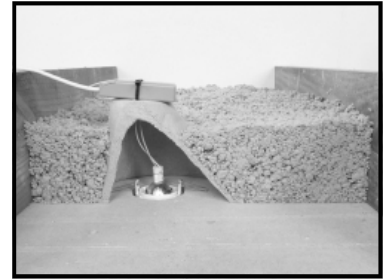

(For full testing and approval details please contact TENMAT Ltd)

### STEP ONE

Make a small hole or slit in the Loft Cone for cable

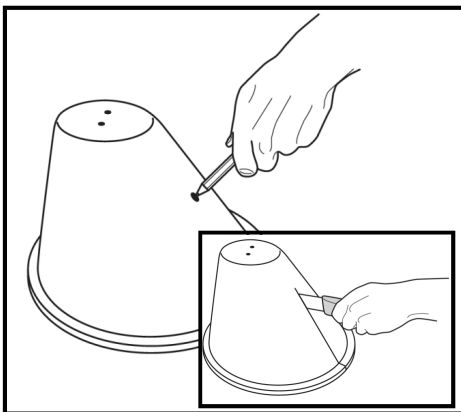

### STEP TWO

After placing cover over downlight, pass cable through Loft Cone and seal up any holes or slits with silicone sealant.

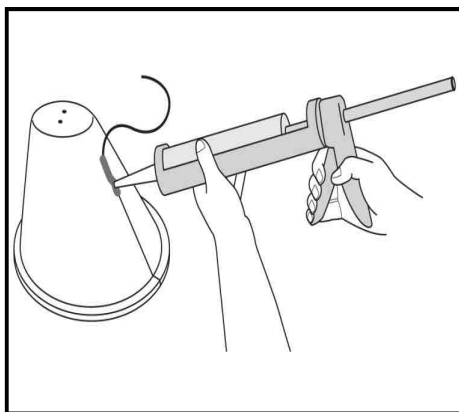

### STEP THREE

If insulation level will not completely cover or bury Loft Cone, the transformer can be located on the top of the Loft Cone, securing with a nylon cable tie.

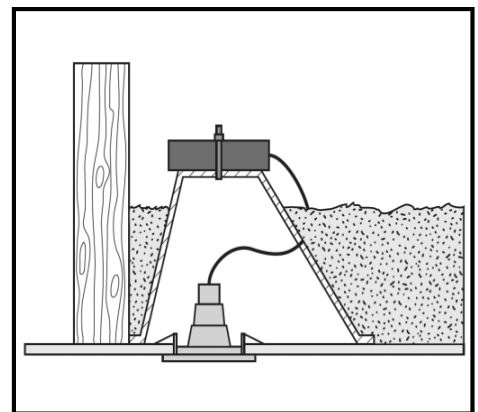

### STEP FOUR

Seal around base of Loft Cone with silicone sealant to secure in place.

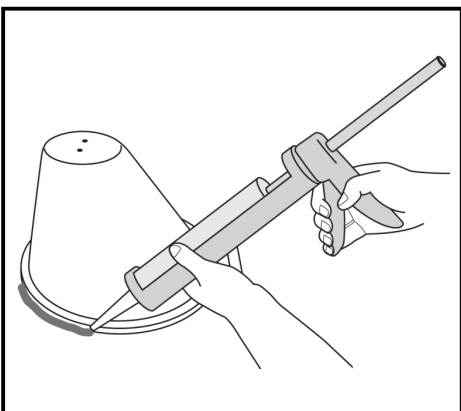

### STEP FIVE

If insulation will cover or bury the Loft Cone, the transformer must be mounted clear of insulation following transformer manufacturer's recommendations.

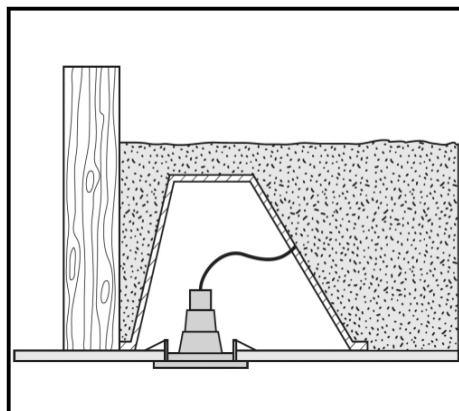

### STEP SIX

NB. The Loft Cone is approved for installation in contact with combustible surfaces, e.g. timber. The downlight must be min. 25mm away from joist.

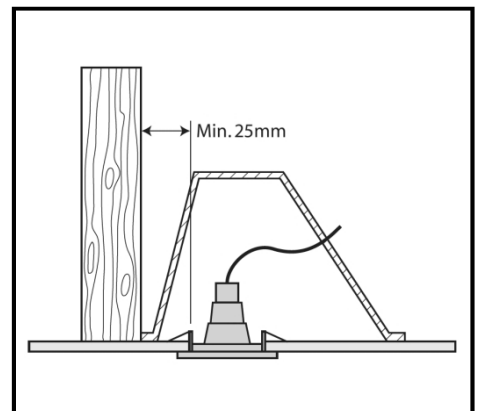

### IMPORTANT

- Max. insulation depth above Loft Cone 270mm
- Ensure transformer mounted clear of insulation
- Do not place transformer under the cover
- Max. lamp wattage 50W
- Downlight should not touch inside of Loft Cone
- Downlights must be fitted in accordance with manufacturer's recommendations
- For further information please contact TENMAT

#### TENMAT LTD

Ashburton Road West,  
Trafford Park, Manchester, M17 1RU  
Telephone: +44 (0)161 872 2181  
Fax: +44 (0)161 872 7596  
Website: [www.tenmat.com.au](http://www.tenmat.com.au) E-mail: [info@tenmat.com.au](mailto:info@tenmat.com.au)